

Cal. 5020.B

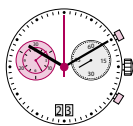

English User's Manual

Battery type: 395 (diameter 9.5mm x 2.6mm / SR 927 SW)
Accuracy: +20 / -10 seconds per month



Description of the display and control buttons

Display elements

Minute hand
Hour hand
Minute counter
Hour counter
Centre stop-second
Second hand
Date

Control buttons

Push-button A
Crown
Push-button B

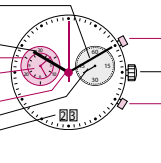

Hour counter Push-button A

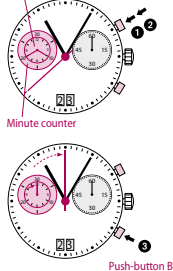

Chronograph: Basic function

(Start / Stop / Reset)

Example:

1 Start: Press push-button A.

2 Stop: to stop the timing, press pushbutton A once more and read the 3 chronograph counters:
4h / 20 min / 38 sec

3 Zero positioning: Press push-button B. (The 3 chronograph hands will be reset to their zero positions).

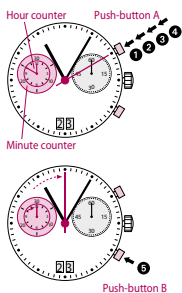

Chronograph: Accumulated timing

Example:

1 Start: (start timing)
2 Stop: (e.g. 15 min 5 sec following 1)
3 Restart: (timing is resumed)
4 Stop: (e.g. 10 min 5 sec following 3)
= 25 min 10 sec
(The accumulated measured time is shown)

5 Reset: The three chronograph hands are returned to their zero positions.

Please note:
* Following 4, the accumulation of the timing can be continued by pressing push-button A (Restart / Stop, Restart / Stop, ...)

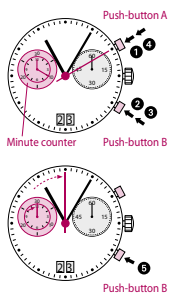

Chronograph: Intermediate or interval timing

Example:

1 Start: (start timing)

2 Display interval: e.g. 10 minutes 10 seconds (timing continues in the background)

3 Making up the measured time: (the 3 chronograph hands are quickly advanced to the ongoing measured time).

4 Stop: (Final time is displayed)

5 Reset: The 3 chronograph hands are returned to their zero position

Please note:
* Following 4, further intervals or intermediates can be displayed by pressing push-button B (display interval / make up measured time, ...)

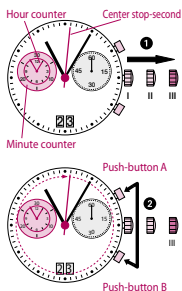

Adjusting the chronograph hands to zero position

Example:
One or several chronograph hands are not in their correct zero positions and have to be adjusted (e.g. following a battery change).

1 Pull out the crown to position III (all 3 chronograph hands are in their correct or incorrect zero position).
2 Keep push-buttons A and B depressed simultaneously for at least 2 seconds (the centre stop-second rotates by 360° → corrective mode is activated).

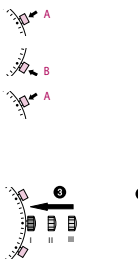

Adjusting the centre stop second

Single step A 1 x short

Continuous A long

Adjusting the next hand B

Adjusting the minute counter hand and the hour counter hand (mechanical coupled)

Single step A 1 x short

Continuous A long

3 Returning the crown to position I
Termination of the chronograph hands adjustment (can be carried out at any time).

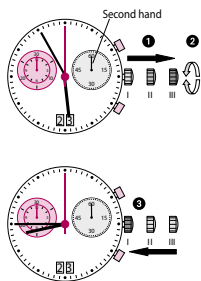

Setting the time

1 Pull out the crown to position III (the watch stops).
2 Turn the crown until you reach the correct time 8:45.
3 Push the crown back into position I.

Please note:
* In order to set the time to the exact second, 1 must be pulled out when the second hand is in position «00». Once the hour and minute hands have been set, 2 must be pushed back into position I at the exact second.

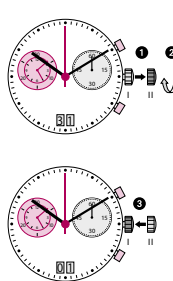

Setting the date (quick mode)

1 Pull out the crown to position II (the watch continues to run).
2 Turn the crown until the correct date 12 appears.
3 Push the crown back into position I.

Please note:
During the date changing phase between 9 PM and 12 PM, the date must be set to the date of the following day.

An extreme acceleration in setting the date with quick mode can induce a false date indication. The synchronization is re-established by setting the date from 01 till 31 (crown in position II).

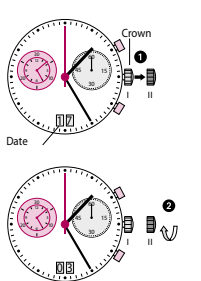

Setting the date/time

Example:
- Date / time on the watch: 12 / 1:25 AM
- Present date / time: 4 / 8:30 PM

1 Pull out the crown to position II (the watch continues to run).
2 Turn the crown until yesterday's date appears 3.

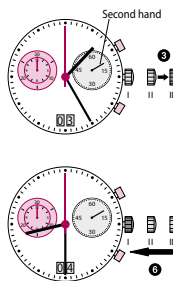

3 Pull out the crown to position III (the watch stops).
4 Turn the crown until the correct date 4 appears.
5** Continue to turn the crown until the correct time 8:30 PM appears.
6 Push the crown back into position I.

Please note:
* To set your watch to the exact second, please refer to the chapter entitled «setting the time».
** Please observe the AM/PM clock rhythm.